

PINE CREEK CONDOMINIUMS COMMUNITY PLAN

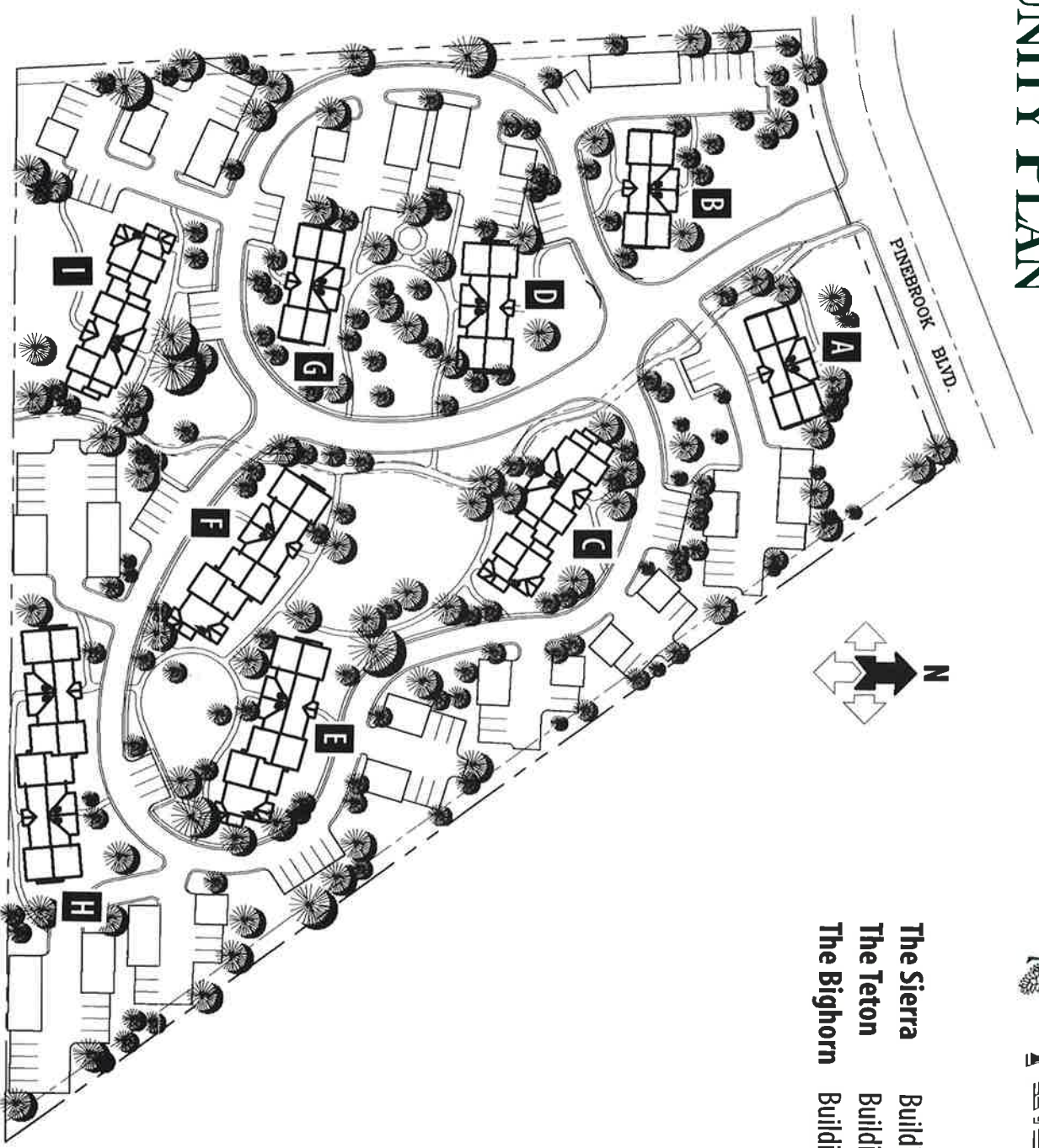

PINE CREEK

- The Sierra** Buildings A, B & G
- The Teton** Buildings C & I
- The Bighorn** Buildings D, E, F & H



PINE CREEK CONDOMINIUMS / PARK CITY, UTAH / LAYOUT DESIGN IS ARTIST'S CONCEPTION. DIMENSIONS AND POSITIONING MAY VARY.

PINE CREEK CONDOMINIUMS AT PINEBROOK, PARK CITY, UTAH

Standard Home Features

Interiors

- Δ Mountain-style interiors and exteriors with architectural detailing for base, case, doors and windows
- Δ Sound attenuation system includes Gypcrete sound insulation and double-layered ceiling drywall
- Δ Full-length mirrors in all baths
- Δ R-19 insulation in exterior walls and R-38 in the ceiling of the roof.
- Δ Double-pane insulated vinyl windows
- Δ General Electric appliances — microwave, stove, oven and disposal
- Δ 30-year architectural grade asphalt roof system
- Δ Washer/dryer hookups
- Δ Private balcony deck with each condominium
- Δ Gas heating system
- Δ Pre-wired for TV cable and telephone
- Δ Gas fireplace
- Δ Jetted tub in master bathrooms
- Δ Double vanities in master bath
- Δ 12" tile floor in all bathrooms
- Δ Fire sprinklers
- Δ 9' ceiling height with vaulted ceilings in upper level
- Δ Split log mantle

Exteriors

- Δ Exterior of buildings and landscaping maintained by condominium homeowners association
- Δ Fully landscaped
- Δ 2" x 6" exterior wall construction
- Δ Stone veneer, stucco and wood siding exterior materials
- Δ Private enclosed garage

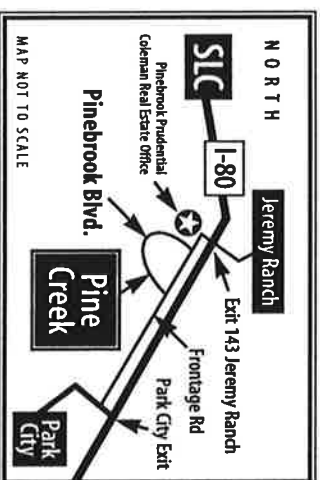

Take the frontage road from either the Jeremy Ranch exit or Kimball Junction/Park City exit and turn into Pinebrook Blvd., by the Crystal View apartments. Pine Creek is on the south side of the road directly behind Crystal View. Stop at The Prudential Coleman Real Estate office in the familiar log cabin or visit our sales trailer at the site for information.

MARKETED BY
THE PRUDENTIAL COLEMAN REAL ESTATE
PINEBROOK 649-7930 OR 521-5386

AND
THE WATTS REAL ESTATE GROUP
SALT LAKE 801-278-1560

ALL PRICES AND PLAN SPECIFICATIONS ARE SUBJECT TO CHANGE WITHOUT NOTICE.